

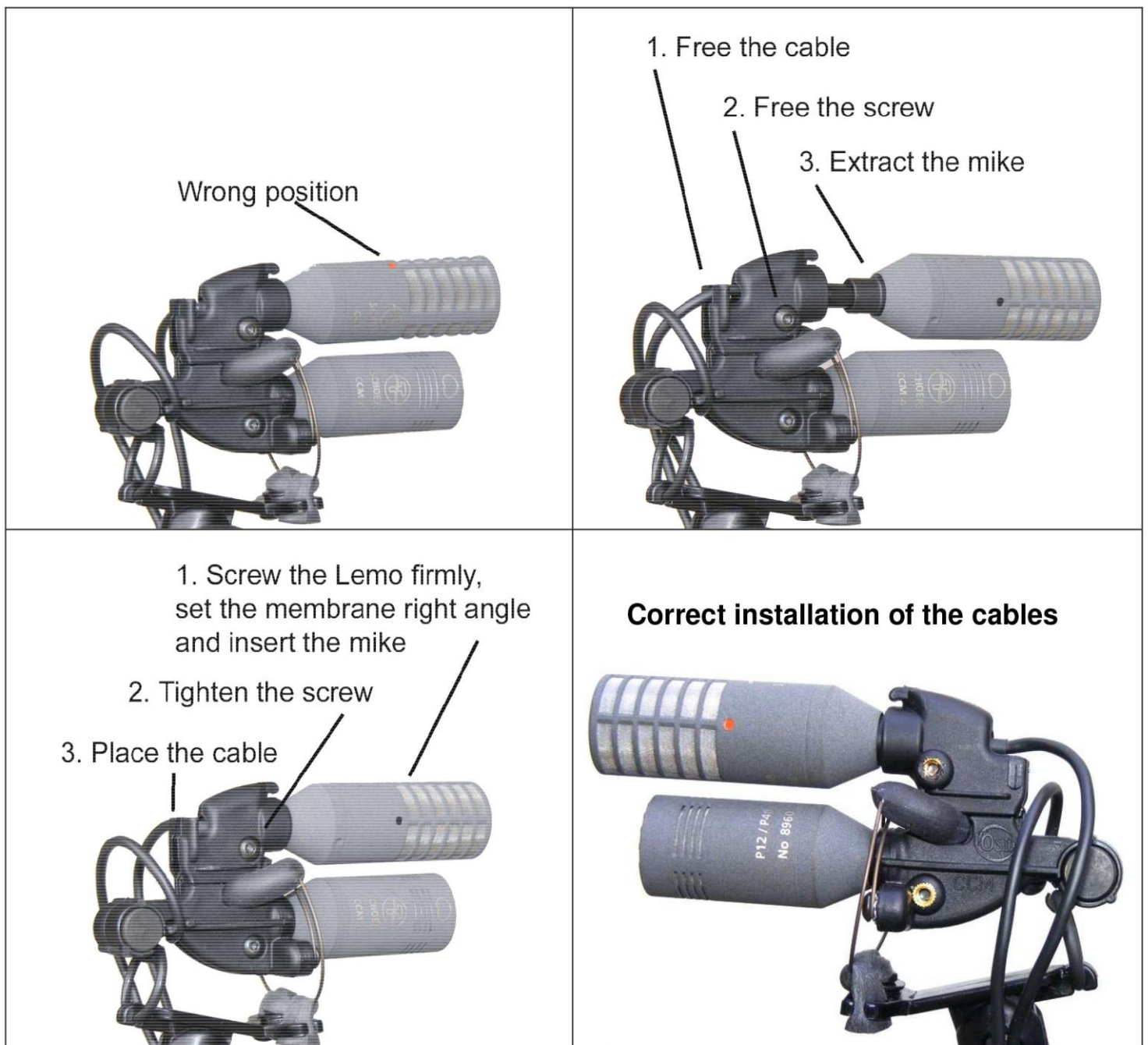

Setting procedure for the CCM 8 installation

At the first installation of your MS pair CCM 4/8, you may find that the CCM 8 (figure of 8) has a wrong orientation. Here are all steps to set it.



Note: The side screw has to be tightened quite firmly. Always screw or unscrew it with the microphone in position.

Z-CABLE-CCM-MS



Disassembly:
to release the Lemo mono cable you must unscrew the M3 screw
which is under the label M

Protective EPDM strip: leave 4/5 mm overhang

When the new cable is installed, it is advised to insert
a very tiny drop of glue into the slot here to avoid cable
rubbing noise.



Due to new choices of cable and wiring, the aperture of the PCB housing must be slightly enlarged with a cutting pliers
or a cutter.

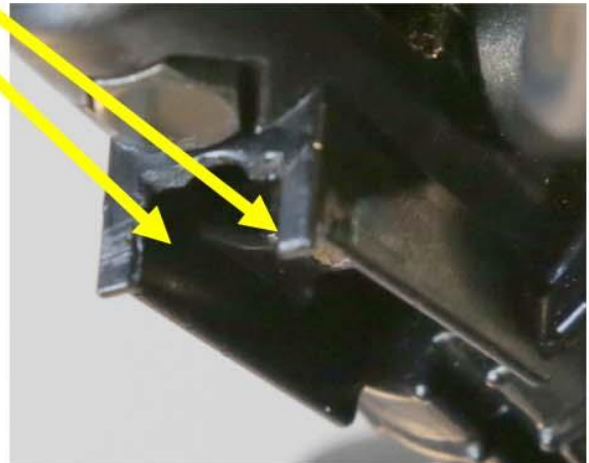

The cable currently used is the Mogami 3031 whose shielding is made of braided copper wires (unlike the single shielded Mogami 2697).

It has a larger outside diameter, which makes installation a bit more difficult.



It is recommended to enlarge the groove (in yellow) using a cutter before starting to install the Mid cable



1- Using a flat screwdriver, move apart the 2 jaws when inserting the cable
2- Continue the operation on the other side



2- Screw the M Lemo on the Mid CCM
4- Holding the CCM, insert the Lemo completely in the groove of the suspension module



5- Side (S) cable installation: Unscrew the two M3 screws in order to release the upper part of the module to pass the cable through, then replace this module, the M3x12 screw + nut is only used to secure the fixation.